

REV	DATE	ECO	DESCRIPTION	BY	CK	APP
-	11-8-99	N/A	INITIAL RELEASE	CRP	N/A	N/A

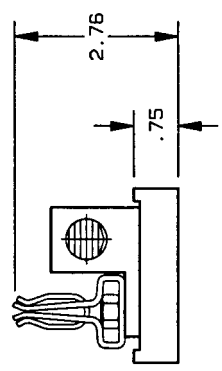
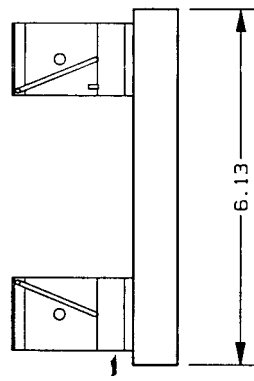
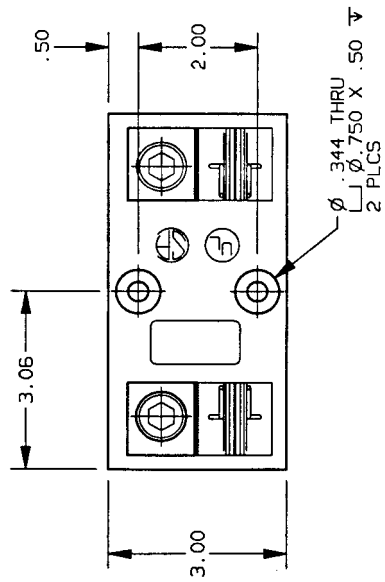

NOTES:

1. MATERIAL COMPOSITION AND RATING:
BASE - THERMOPLASTIC 125°C RTI
2. ALL TOLERANCES ±.010 UNLESS OTHERWISE NOTED

P/N	CONN TYPE	RMS SYM RATING	TORQUE (IN-LBS)	WIRE		U/L		CSA REPORT NO.
				•C	TYPE	FILE NO.	GUIDE NO.	
62001J	AL BOX	200K	375	75	Cu - AL	E52283	1ZLT	LR32169

GOULD
374 MERRIMAC STREET
NEWBURYPORT, MA 01950

PRODUCT MANAGER
SIGN: *Nicholas*
DATE: 11-8-99

DESIGN ENGINEER
SIGN: *Mosier*
DATE: 11/8/99

OUTLINE DIMENSIONS
NOT TO BE USED FOR PRODUCTION

FUSE BLOCK, 600V-200A, 1 POLE
CLASS J

700508